

FIXTURE SCHEDULE					
SYM.	DESCRIPTION	HOT	COLD	WASTE	VENT
DW-1	DISH WASHER - JACKSON VENTLESS MODEL TEMPSTART HH-E PLUMBER TO ROUGH IN, CONNECT COLD WATER, AND CONNECT DRAIN TO FLOOR SINK.	---	3/4"	1-1/2"	---
S-1	CORNER SINK - JOHN BOOS MODEL 3PBCS1620-2D18, 12" DEEP BOWL STAINLESS STEEL 16GA. 14-814L KRONNE ROYAL FAUCET. PLUMBER TO ROUGH IN, CONNECT CN & HN, AND CONNECT DRAIN TO GREASE TRAP.	1/2"	1/2"	TO GT-1	1-1/2"
S-2	SOILED SINK - JOHN BOOS MODEL JDT5-20-60L-X DISHTABLE FOR LEFT-TO-RIGHT OPERATION. KRONNE MODEL IT-108XL ROYAL SERIES FAUCET. PLUMBER TO ROUGH IN, CONNECT CN & HN, AND PROVIDE & INSTALL DISPOSAL.	1/2"	1/2"	1-1/2"	1-1/2"
S-3	PREP SINK - JOHN BOOS MODEL E150-1620-12L18-X DISHTABLE. KRONNE MODEL 14-812L ROYAL SERIES FAUCET. PLUMBER TO ROUGH IN, CONNECT COLD WATER, AND CONNECT DRAIN TO FLOOR SINK.	1/2"	1/2"	1-1/2"	1-1/2"
S-4	WALL HUNG HAND WASH SINK - KRONNE METAL MODEL H5-2L 16 WIDE HAND SINK. 4" OC SPLASH MOUNT GOOSENECK FAUCET. PLUMBER TO ROUGH IN, CONNECT COLD WATER, CONNECT DRAIN TO FLOOR SINK. WITH 1/2" BALL STOPS, AND 1-1/2" CHROME P-TRAP.	1/2"	1/2"	1-1/2"	1-1/2"
FS-1	FLOOR SINK - ZURN Z-1900-KC WITH WHITE ENAMEL FINISH, DOME STRAINER AND 4" DEEP SEAL P-TRAP. PROVIDE 3/4" GRATE OVER SINK.	---	---	4"	2"
L-1	ADA COUNTERTOP LAVATORY - EXISTING LAVATORY TO REMAIN REPLACE WITH MOEN L4601 LEVER FAUCET, MIXING VALVE, K-1115. PROVIDE INSULATING JACKET ON HN & DRAIN UNDER LAVATORY.	1/2"	1/2"	1-1/2"	1-1/2"
GT-1	GREASE TRAP - ZURN Z1110 (SIZE 600) 50# 15 GPM FLOW FLOOR MOUNTED GREASE TRAP. PROVIDE TRAP WITH Z110B FLOW CONTROL FITTING. INTERCEPTOR LID TO BE ACCESSIBLE FOR GREASE REMOVAL.	---	---	3"	2"
JS-1	FLOOR MOUNTED SERVICE SINK - KOHLER K-6110 "WHITBY" W/ K-8440 WIRE RIM GUARD, K-8420 FAUCET ASSEMBLY AND K-9142 STRAINER WITH DEEP SEAL P-TRAP.	1/2"	1/2"	2"	2"
FD-1	2" FLOOR DRAIN - ZURN Z-415 WITH 5"φ NICKEL-BRONZE STRAINER AND 2" DEEP SEAL P-TRAP. PROVIDE WITH TRAP PRIMER EXCEPT AT SHOWERS.	---	---	2"	2"

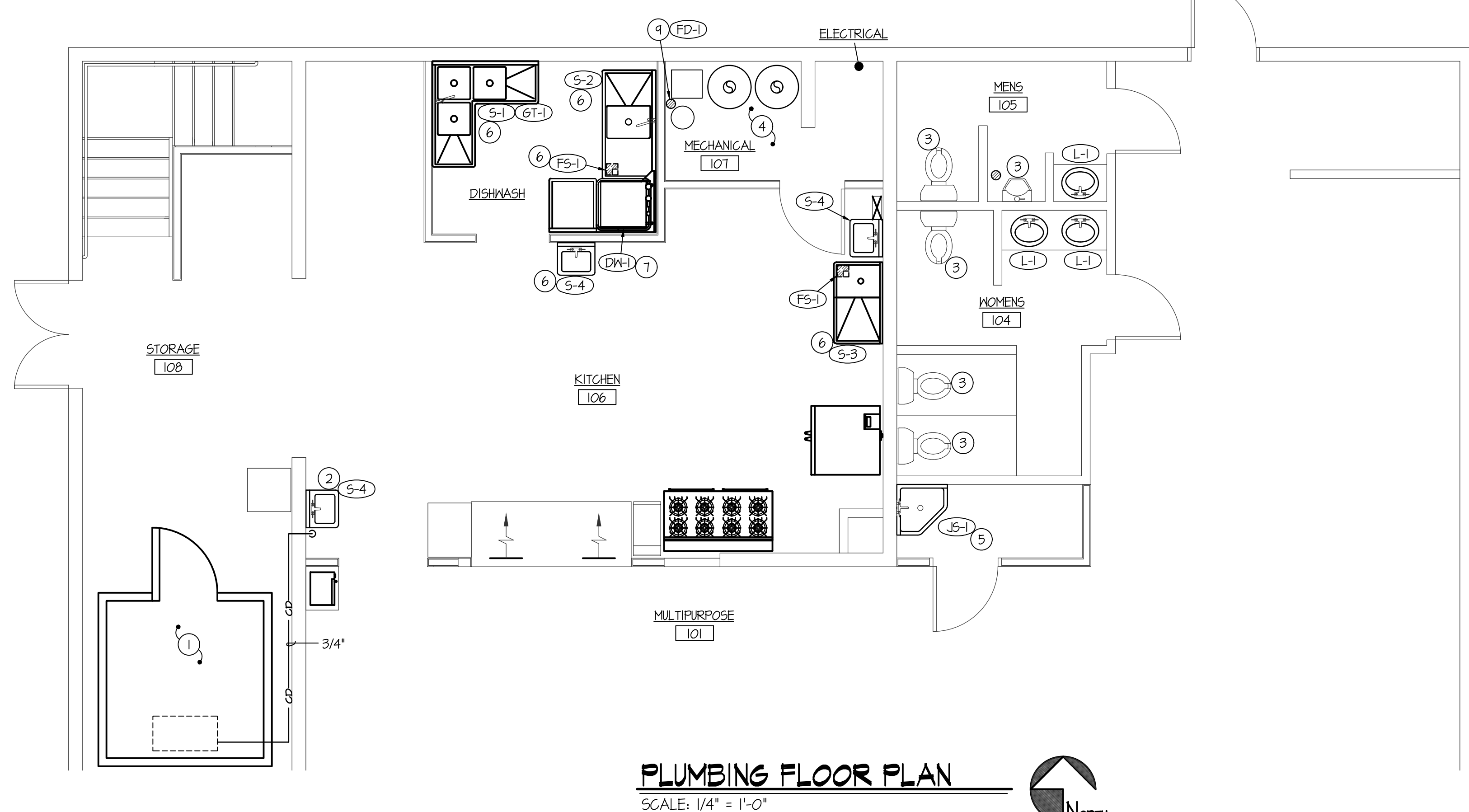
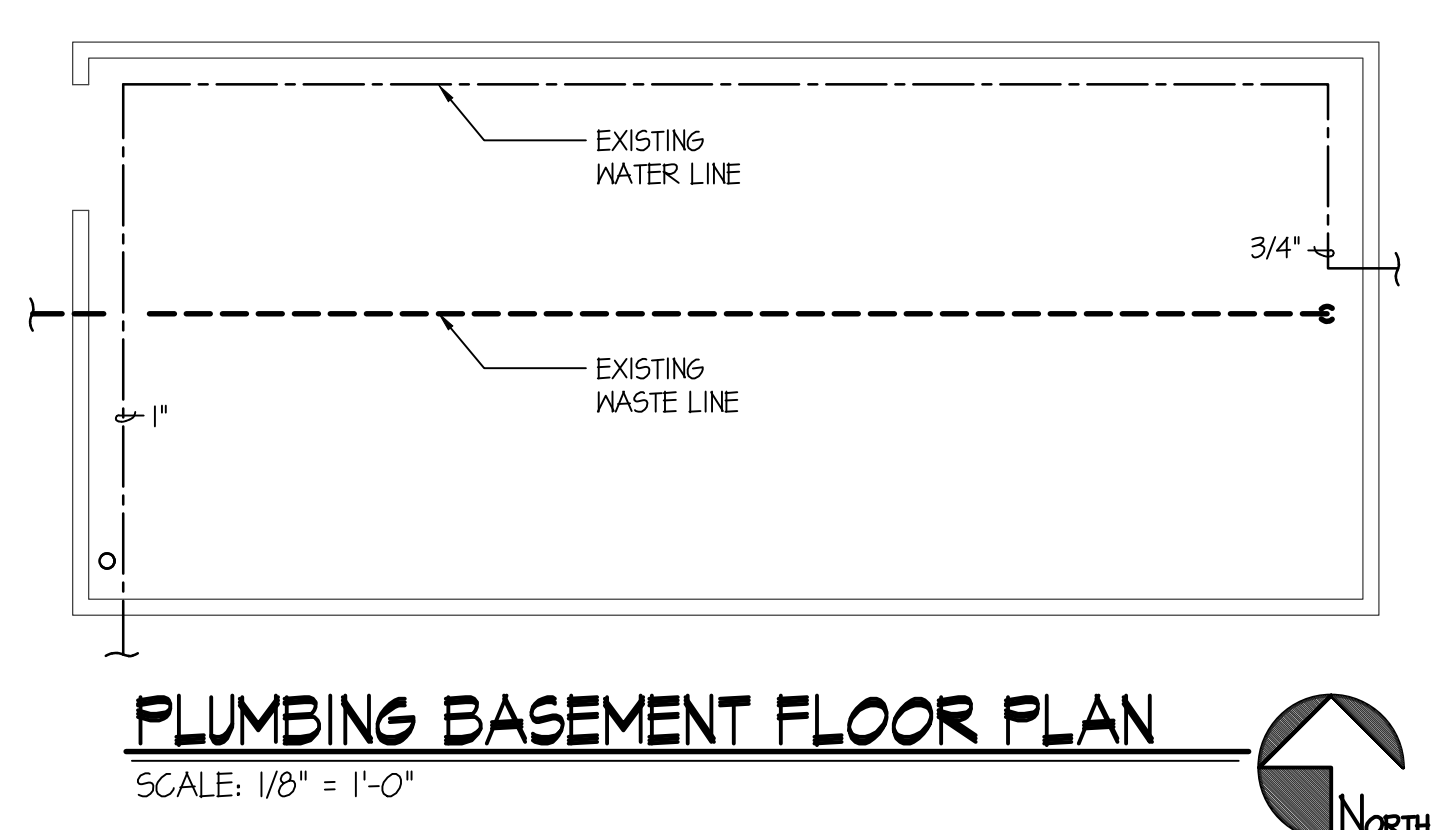
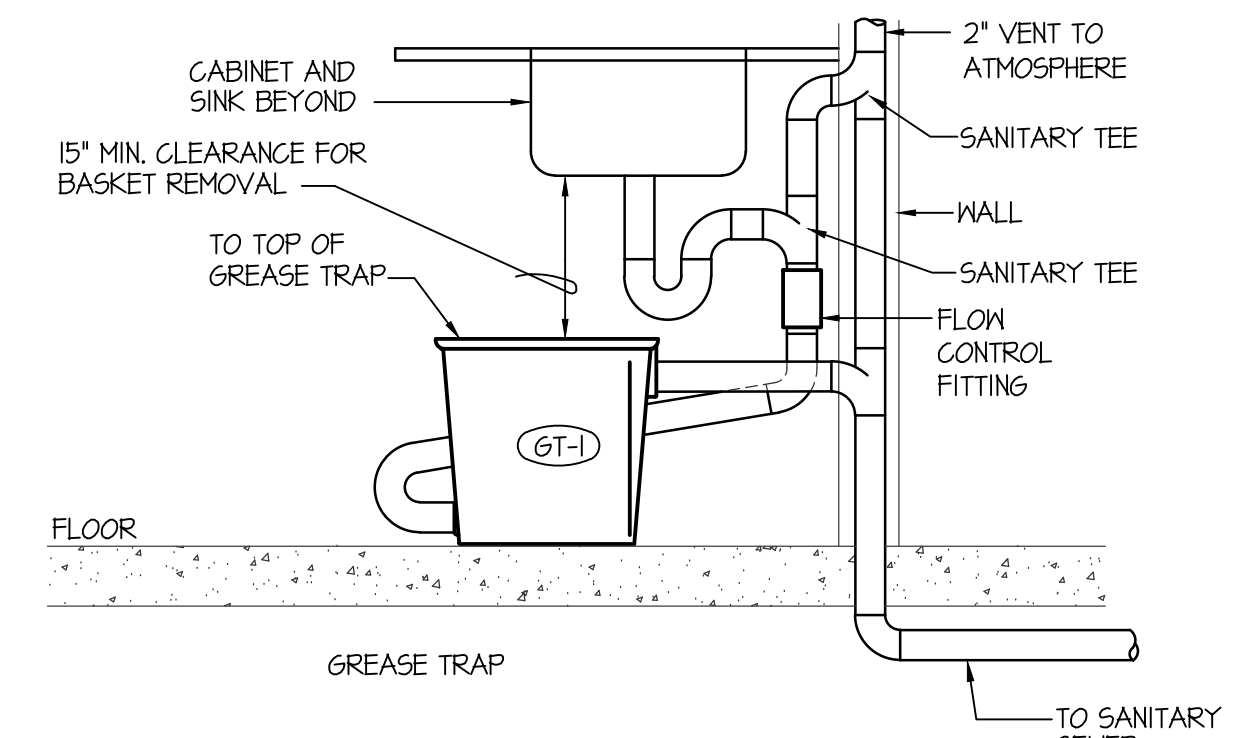
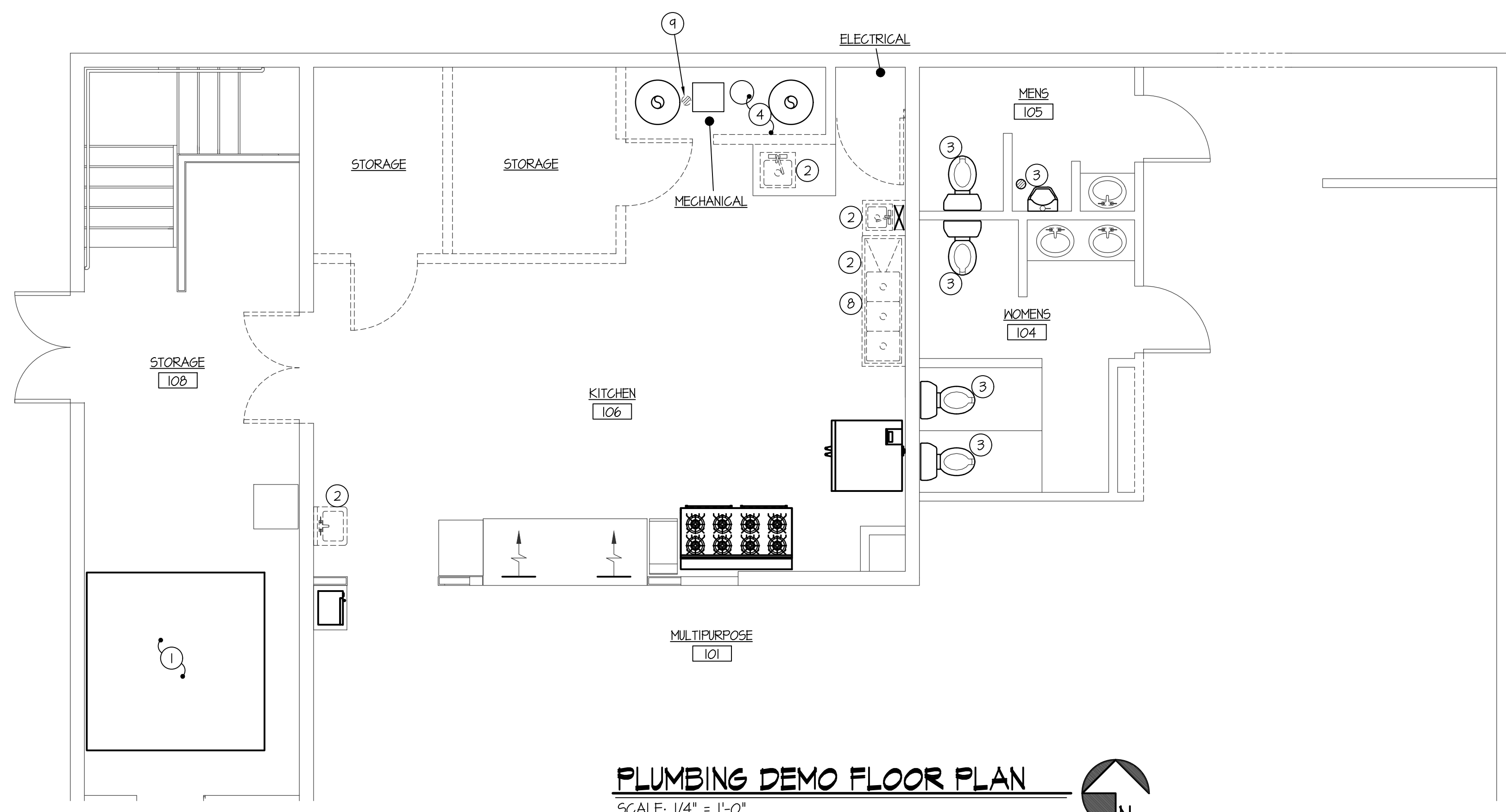

- PLAN NOTES:**
- EXISTING FREEZER TO BE REPLACED. INSTALL NEW 3/4" CONDENSATE LINE FROM FREEZER ACROSS CEILING AS HIGH AS POSSIBLE. DROP DOWN AND CONNECT TO EXISTING 3/4" OR LARGER CONDENSATE LINE. FIELD VERIFY EXACT LOCATION. CONTRACTOR TO INSULATE CONDENSATE LINE LOCATED IN FREEZER AND PROVIDE HEAT TRACE AS REQUIRED. CAP AND ABANDON IF NOT REQUIRED.
 - DISCONNECT AND DISPOSE OF EXISTING FIXTURE. CAP UN-USED WATER AND VENT IN WALL OR UNDER FLOOR AS REQUIRED.
 - EXISTING TOILET, AND URINAL REMAIN PROTECT DURING CONSTRUCTION.
 - REMOVE EXISTING WATER HEATERS AND WATER SOFTENER SYSTEM DURING NEW FLOOR FINISH AND RELOCATE TO NEW LOCATION AS SHOWN. MODIFY VENT, WATER AND GAS LINES AS REQUIRED FOR NEW LOCATIONS. ROUTE WATER HEATERS FRY LINES TO NEW FLOOR DRAIN UNDER DW-1. FIELD VERIFY EXISTING HN & CN ROUTES AND SIZES.
 - PROVIDE AND INSTALL NEW JANITOR SINK IN LOCATION AS SHOWN. RUN WASTE, WATER AND VENT FROM NEAREST EXISTING LINES. CN & HN 1/2" LINE TO BE BRANCHED OFF FROM NEAREST 3/4" OR LARGER.
 - PROVIDE AND INSTALL NEW FIXTURE AS SHOWN. 1/2" HOT AND COLD WATER LINE TO BE BRANCHED OFF NEAREST 3/4" OR GREATER. ROUTE NEW WASTE & VENT TO EXISTING AS REQUIRED. FIELD VERIFY EXISTING WASTE & VENT ROUTE AND ELEVATIONS. EXHAUST HOOD TO REMAIN, PROTECT DURING CONSTRUCTION.
 - RUN 3/4" COLD WATER LINE TO DISH WASHER AS PER MANUFACTURE REQUIREMENTS. RUN 1-1/2" WASTE TO NEW FLOOR DRAIN FOR AN INDIRECT CONNECTION TO WASTE.
 - REMOVE AND DISPOSE OF EXISTING GREASE TRAP.
 - REMOVE EXISTING FLOOR DRAIN FOR NEW FLOOR FINISH. SHIFT LOCATION AS REQUIRED TO CLEAR NEW WALL AND REPLACE WITH NEW.

PLUMBING LEGEND

SYMBOL	DESCRIPTION
V	VENT
VTR	VENT THRU ROOF
CO	CLEANOUT
MCO	WALL CLEANOUT
COTG	CLEANOUT TO GRADE
—○—	PIPE DROP
—○—	PIPE RISE
—○—	BALL TYPE ISOLATION VALVE
---	SOIL OR WASTE PIPING
---	VENT LINE PIPING
---	DOMESTIC COLD WATER PIPING
---	DOMESTIC HOT WATER PIPING
---	HOT WATER RECIRC. PIPING
—G—	GAS PIPING
—GD—	CONDENSATE DRAIN PIPING
—RDL—	ROOF DRAIN PIPING
—RDO—	ROOF OVERFLOW DRAIN PIPING

- GENERAL NOTES:**
- THE CONTRACTOR SHALL CHECK AND VERIFY ALL DIMENSIONS AND CONNECTIONS ON THE JOB SITE. ALL WORK SHALL BE EXECUTED FROM MEASUREMENTS TAKEN AT THE SITE.
 - THE MECHANICAL CONTRACTOR SHALL BE RESPONSIBLE TO INSURE PROPER CODE CLEARANCES FOR ELECTRICAL AND MECHANICAL ACCESS WHEN INSTALLING ANY EQUIPMENT SUPPLIED BY THE MECHANICAL CONTRACTOR.
 - IT IS CRITICAL THAT THIS CONTRACTOR COORDINATE EQUIPMENT LOCATIONS WITH PIPING, DUCTWORK, ELECTRICAL CONDUIT AND BUILDING STRUCTURE TO INSURE CODE COMPLIANCE.
 - CELLING DIFFUSERS ARE SHOWN IN APPROXIMATE LOCATIONS. REFER TO LIGHTING PLANS AND REFLECTED CEILING PLAN FOR EXACT LOCATIONS.
 - DUCT DIMENSIONS CALLED OUT ON DRAWINGS ARE INSIDE FREE AREA DIMENSIONS. ACOUSTICAL DUCT LINER ARE TO BE ADDED TO OVERALL MEASUREMENTS.
 - ALL DUCTWORK AND PIPING WHICH PASSES THRU FIRE RATED WALLS TO BE FIRE STOPPED WITH APPROVED FOAM OR SEALANT. REFER TO SPECIFICATIONS FOR APPROVED MANUFACTURES.

ORIGINAL DRAWING SIGNED BY: DWAYNE C. SUDWEEKS
DATE ORIGINAL SIGNED: Oct 28, 2018
ORIGINAL ON FILE AT ENGINEERED SYSTEMS ASSOCIATES
1355 EAST CENTER, POCATELLO, IDAHO 83201

Engineered Systems Associates
1355 EAST CENTER
POCATELLO, IDAHO 83201
PHONE: (208) 233-0501
FAX: (208) 233-0529
EMAIL: esa@engsystems.com
ESA JOB NUMBER: 18045

nbw architects p.a.
ARCHITECTURE / PLANNING / INTERIORS
SCOTT NELSON, A.I.A. KEVIN R. BODILY, A.I.A. JAMES H. WYATT, A.I.A.
900 NORTH OREGON PARKWAY, P.O. BOX 2212 • IDAHO FALLS, IDAHO 83402-2212
(208) 743-5372 • (208) 743-5373 • (208) 743-5374 • (208) 743-5375

REMODEL FOR:
SHELLEY SENIOR CENTER
193 W. PINE ST.
SHELLEY, ID 83274

PROJECT:
REVISIONS:

PROJECT NO.
18023
DATE
OCTOBER 2018
DRAWN BY:
T DRAVIS
CHECKED BY:
D SUDWEEKS

DRAWING NO.:
P1.1